

Dimension: (Unit: mm)

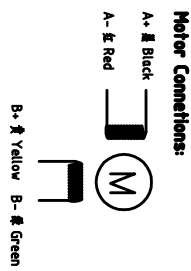

Encoder Signals

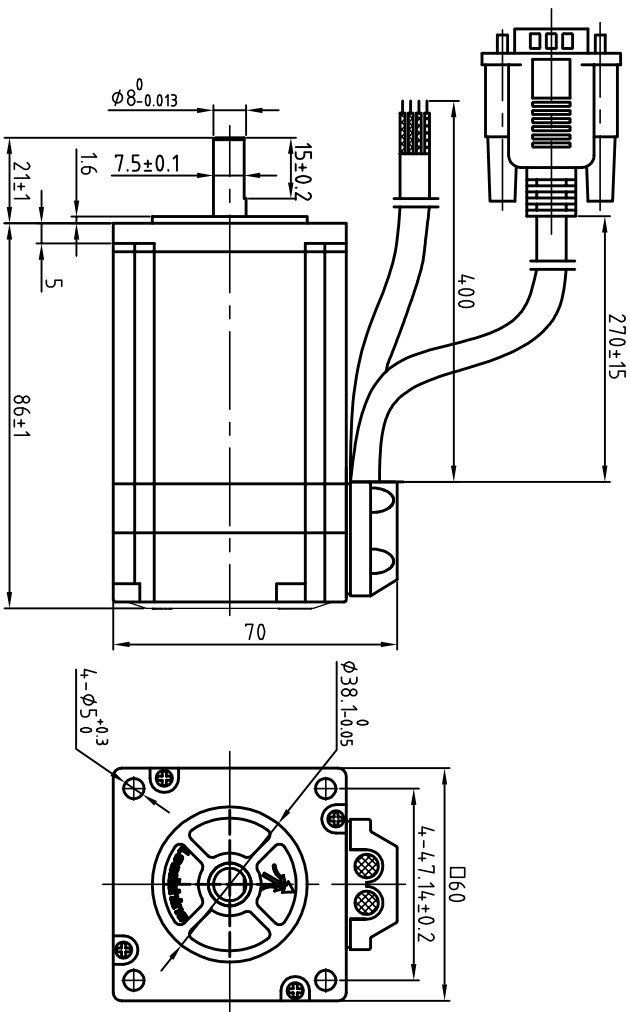
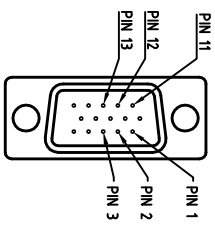

PIN	颜色	定义
1	黑	A+
2	红	VCC
3	白	GND
11	黄	B+
12	绿	B-
13	蓝	A-

Common Rating

Step angle	1.8°
Position accuracy	1.8±0.09°
Dielectric strength	500VAC 1min
Insulation resistance	100MΩhm(500VDC)
Insulation class	B
Temp rise(Max)	80K
Radial play	Max:0.02mm(load 4.50g)
Axial play	Max:0.08mm(load 900g)

Specification:

Current/phase	5.0 A
Voltage	16 V
DC Resistance/phase ±10%	0.32 Ω
Inductance/phase ±20%	1.13mH
Holding torque	2.1 N·M
Inertia	0.57 kg·cm ²
Weight	1.4 kg
Encoder resolution	1000 cpr

设计 Designed	王洪松	日期 Date	17.05.02	材料 Material	第一角画法 First Angle projection			设计 Title	深圳市雷赛智能控制股份有限公司 SHENZHEN LEADSHINE TECHNOLOGY CO., LTD.
审核 Checked	袁继章	17.05.02		版本/版次 Ver. / Scale	A / 01	比例 Scale	图例 Legend	混合伺服电机	
批准 Approved	袁继章	17.05.02		共 1 套 第 1 套 Total 1 set of 1	Sheet 1 of 1			D57CME21 MS30	
图号 Part No.	LS-MT-01-07A			图号 DWG. NO.	LS-D57CME21 MS30				