

Dimension: (Unit: mm)

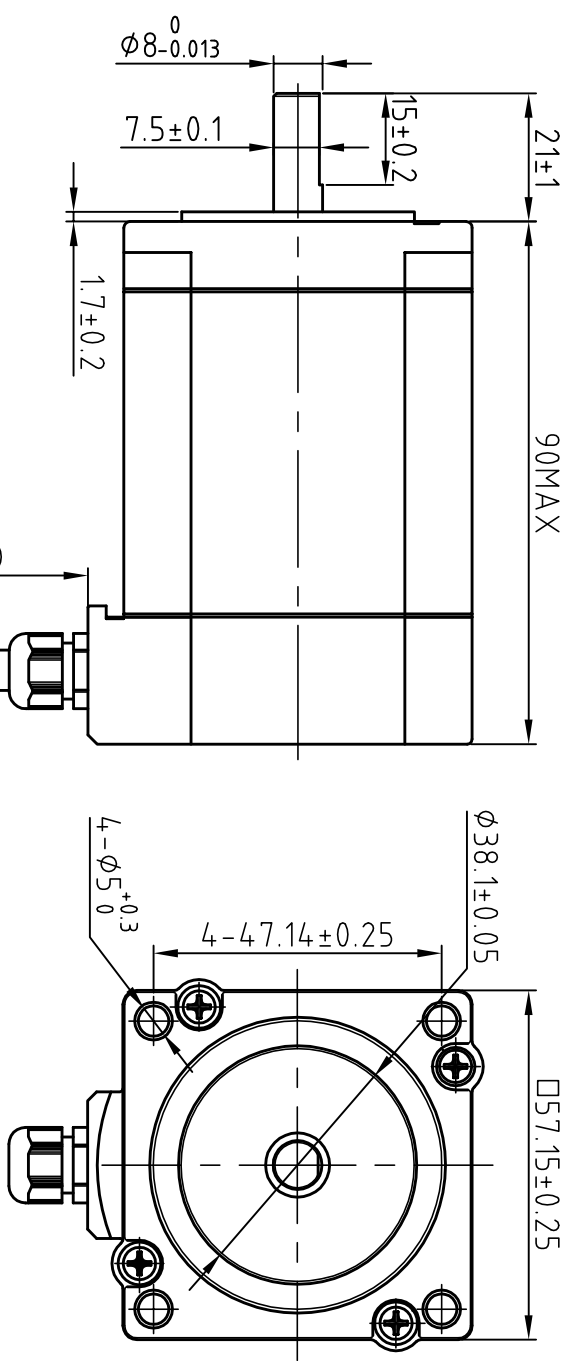

Motor Conenctions:

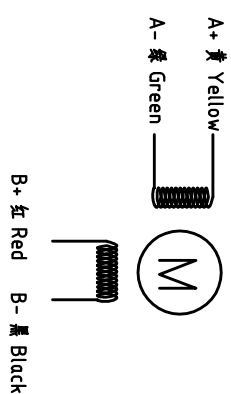

Common Rating

Step angle	18°
Position accuracy	1.8±0.09°
Dielectric strength	500VAC 1min
Insulation resistance	100MΩhm(500VDC)
Insulation class	B
Protection level	IP65
Temp rise(Max)	80K
Radial play	Max:0.02mm(load 4.50g)
Axial play	Max:0.08mm(load 900g)

Specification:

Current/phase	3.0 A
Voltage	4 V
DC Resistance/phase ±10%	1.3 Ω
Inductance/phase ±20%	4.4 mH
Holding torque	2.1 N·M
Inertia	0.48 kg·cm ²
Weight	1.0 kg

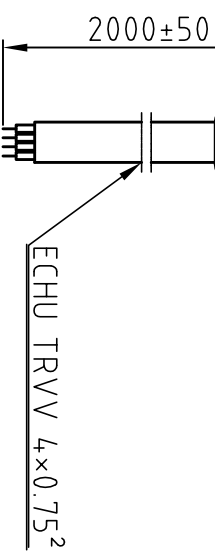

设计 Designed	王洪松	日期 Date	2017.10.30	材料 Material	第一角画法 First angle projection			图例 Title	深圳市雷赛智能控制股份有限公司 SHENZHEN LEADSHINE TECHNOLOGY CO., LTD.
审核 Checked	查捷建		2017.10.30		比例 Scale	1:1	阶段图章 Stage Mark		混合式步进电机
批准 Approved	查捷建		2017.10.30		A/01				57CM23-FS
料号 Part No.	LS-MT-01-07A			共 1 套 第 1 套	Sheet 1 of 1			图号 DWG. NO.	LS-57CM23-FS

版本 Rev	日期 Date	变更文件号 ECU NO.	变更内容 Revisions	设计 By
V1.0	17.10.30		防水型步进电机	王洪松